



- Protected connection point, e.g. for an IP camera
- Complete set including assembly parts

Weatherproof Connection For Network Devices



Universal network connector for installation cables, MOBOTIX patch cables and standard patch cables

Connection Option A: Weatherproof Connection Patch Cable To Installation Cable (e.g. Cat. 7)

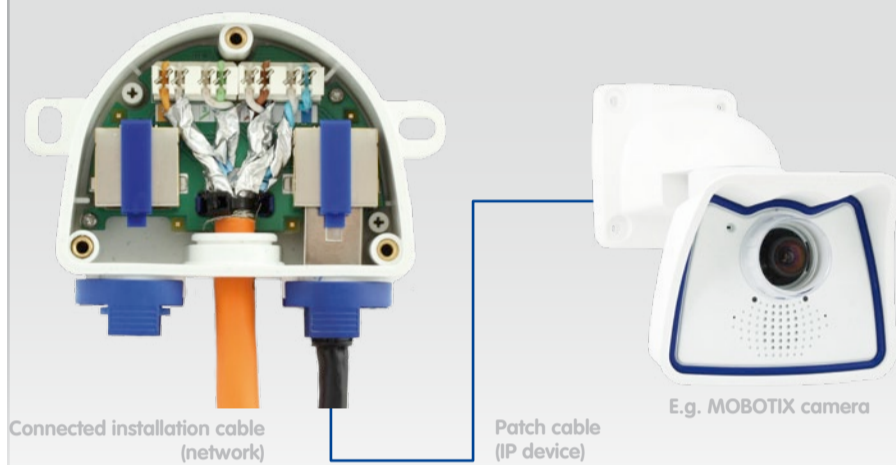

Assembly Instructions

1. Prepare the installation cable

Strip the installation cable for at least 45mm and separate the individual wires of the cable into twisted pairs with 30mm shielding. Wrap the end of the cable shield around the twisted pairs in a width of 10mm so that later it can rest on the contact surface in the PatchBox.

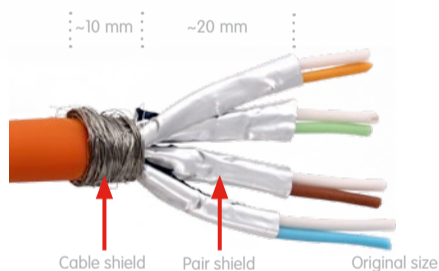

2. Mount the box and insert the cable tie

Attach the PatchBox on the wall with the cable ports pointing down. Remove the box cover (three screws) and feed the supplied cable tie through the two slots on the back.



3. Feed the cable into the box

Replace the sealing plug in the middle with the port plug and feed the installation cable through it. In order to prevent humidity entering the box, the rubber sleeve needs to be tight against the cable (diameter of the cable: 5-10mm). Pull the cable tie, which also serves as a strain relief, tight around the cable shield.

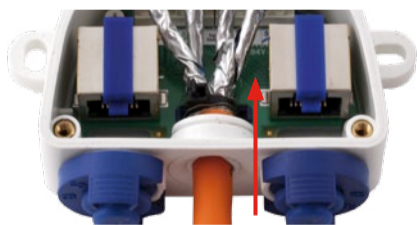

4. Connect the cable wires

The PatchBox contains an LSA terminal to connect the individual wires of the installation cable. Use a wire insertion tool for this. Make sure you follow the designated EIA/TIA-568B color coding scheme. If you are using a cable that complies with TIA-568A, connect the green wires to the orange terminal points, and the orange wires to the green terminal points. Screw the cover back onto the box.

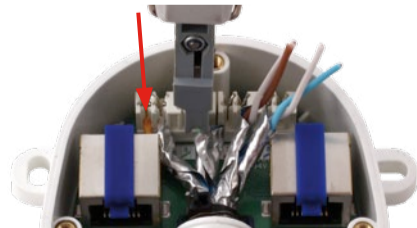

5. Attach the patch cable

Insert a MOBOTIX patch cable into either the left or right port and secure it using the bayonet catch (remove sealing plug first). A MOBOTIX sealing system for standard patch cables will be available soon.

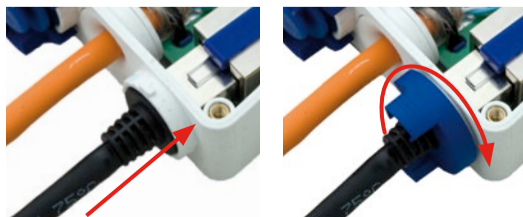

HiRes Video Innovations

The German company MOBOTIX AG is known as the leading pioneer in network camera technology and its decentralized concept has made high-resolution video systems cost efficient.

MOBOTIX AG • 67722 Langmeil, Germany • Tel.: +49-6302-9816-103 • Fax: +49-6302-9816-190 • sales@mobotix.com

Connection Option B: Weatherproof Connection Patch Cable To Patch Cable

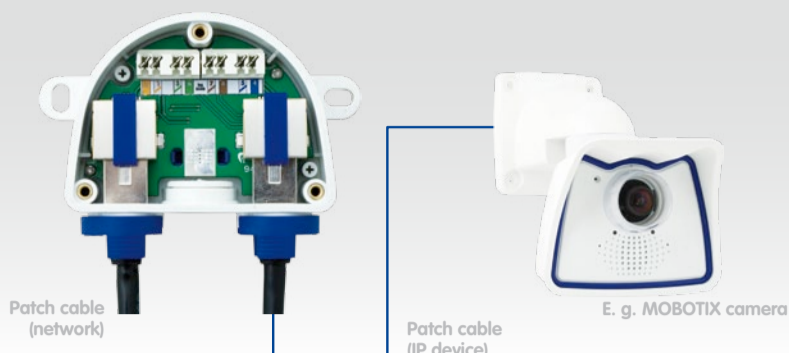

The patch cables with integrated washers (available from MOBOTIX in different lengths) are simply inserted into the RJ45 connectors and fastened using the bayonet catch (1x patch cable to end device, 1x patch cable to PoE switch/injector). It is not necessary to open the box.

Notes

- Position of the drilling holes when using a M24 Wall Mount: see drilling template below
- Maximum torque for all box cover screws: 0.4 Nm
- Only one end device (e.g. MOBOTIX camera) can be connected to the PatchBox
- All unused ports must be closed with the supplied rubber seals
- Pay attention to the correct twisting and shielding of the installation cable
- For measuring see EN 50173-1 Class D STP Chan (FastEthernet, Frequenzbereich 1 to 100 Mhz)

If the technical guidelines and information stated herein are not followed exactly, the manufacturer cannot be held liable under the German Product Liability Act.

Using Standard Patch Cables

Currently you can only use original MOBOTIX patch cables to connect to the RJ45 connectors. Standard cables purchased from other suppliers do not meet the necessary specifications for proper fastening and sealing (no longer weatherproof according to IP65).

MOBOTIX will be offering a sealing system for standard **RJ45 patch cables in the near future.**



Copyright © MOBOTIX AG 2011 • Made in Germany • Technical information subject to change without notice.

Drilling Template For The New M24 Wall Mount

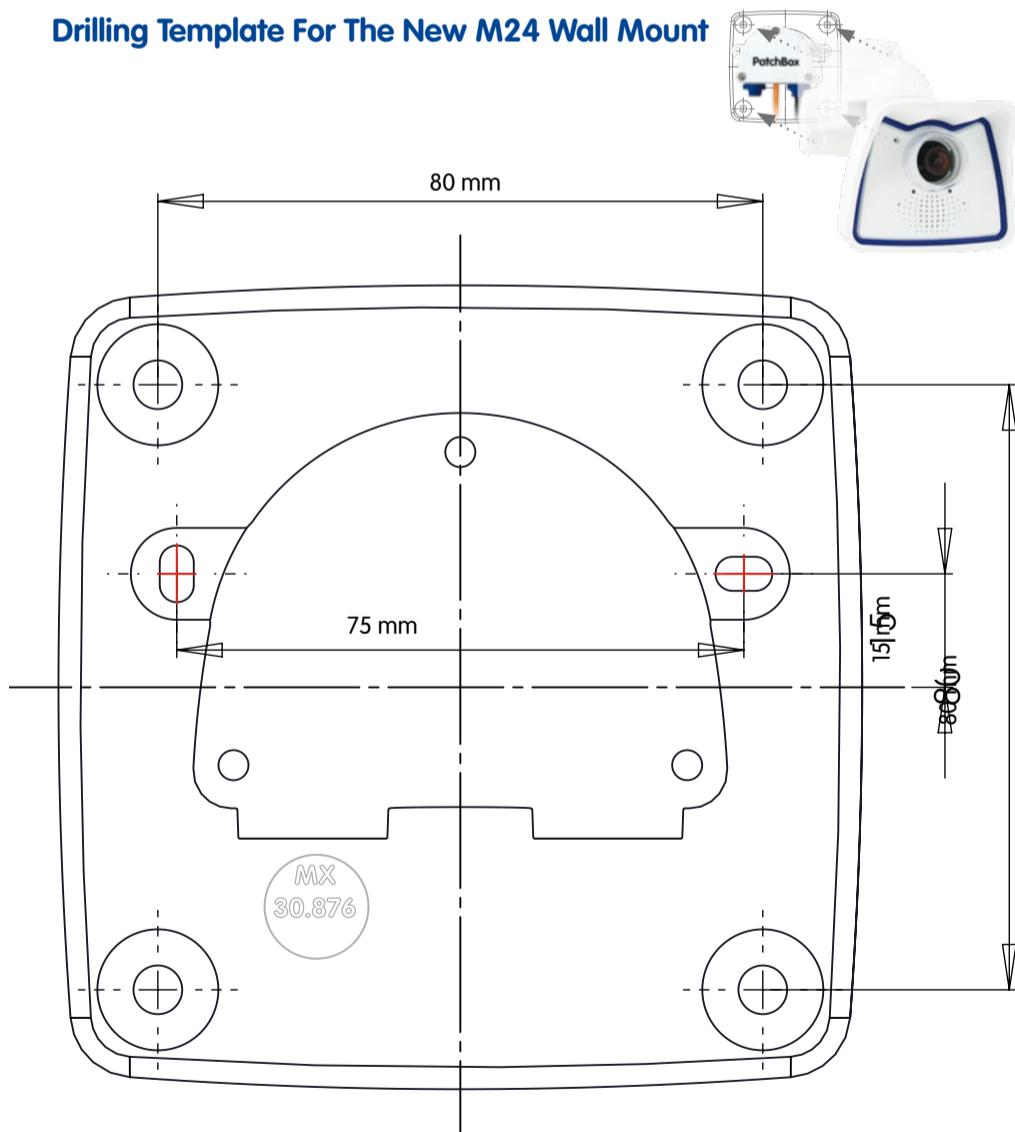

Drilling Templates For Other MOBOTIX Wall Mounts:
www.mobotix.de > Support > Manuals

HiRes Video Innovations

The German company MOBOTIX AG is known as the leading pioneer in network camera technology and its decentralized concept has made high-resolution video systems cost efficient.

MOBOTIX AG • 67722 Langmeil, Germany • Tel.: +49-6302-9816-103 • Fax: +49-6302-9816-190 • sales@mobotix.com