



## Weatherproof Power Supply for MOBOTIX MxBus Modules



- 1 terminal for ext. power supply 12–48 V DC
- 2 MxBus terminals (2 x 2 for MxBus master and for additional MxBus modules)

Alternative power supply for several MxBus modules.

More information: [www.mobotix.com](http://www.mobotix.com) > Products > Accessories > Interface Boxes

### Connection Example

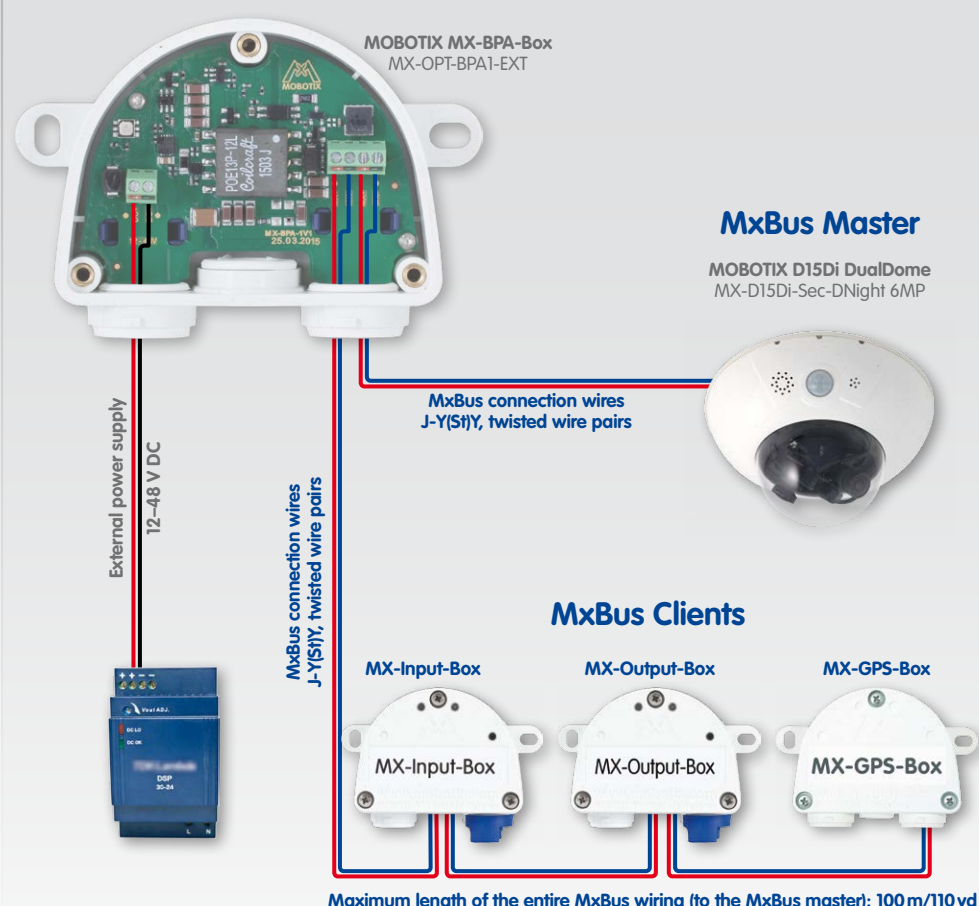

#### Caution

- One MX-BPA-Box must not be connected to more than one camera (MxBus master)!
- Make sure that only one MX-BPA-Box is connected to one MxBus!

### Installation Instructions

#### 1. Attach the box

Attach the MX-BPA-Box at the mounting position with the cable ports pointing downward (torque 0.4 Nm). Next, remove the box cover (three screws).

#### 2. Establish connection to the camera

- **Before proceeding, make sure there is no current on the MxBus wires!**
- Cut the MxBus cable to size (2-wire, 0.6–0.8 mm diameter). When using **wires without jacket**, strip the insulation of the wires for 5 mm and push the wires through the eight-wire plug (center).
- When using a **cable with jacket**, remove the pre-installed eight-wire plug and insert the appropriate cable plug (3 to 5 mm or 5 to 7 mm). Press the rubber plug into the casing in such a way that the rims stick out equally on both sides. Push the cable through the plug, remove the sheath on a length of 15 mm and strip the insulation of the wires for about 5 mm.
- Connect the MxBus wires to the terminals of the MX-BPA-Box using the screwdriver. Make sure to maintain the polarity (see sticker in front of the terminal).
- Connect the MxBus wires as described in the corresponding manual to the MOBOTIX camera or to another MxBus module connected to a camera (e.g. KeypadRFID, MX-DoorMaster). Make sure not to exceed the overall length of the MxBus wiring (max. 100 m/110 yd).

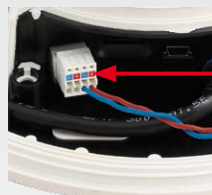
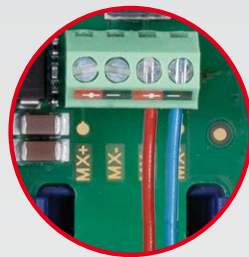
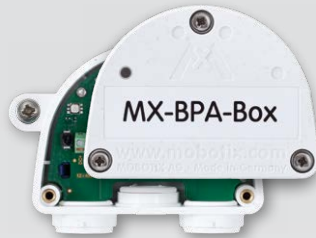

MxBus plug in MOBOTIX D15Di

#### 3. Connect the peripheral devices

Connect the other wires/cables as required and use the corresponding cable plugs (power supply, MxBus).

#### 4. Tie down the cables

Insert both cable ties as shown. Pull the cable ties tightly around the wires in order to provide strain relief.

#### 5. Mount the cover

Mount the cover back onto the MX-BPA-Box and tighten it using the cover screws (torque 0.4 Nm).

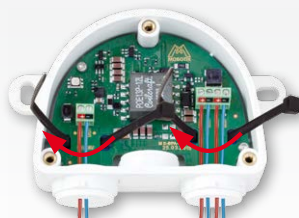

#### Innovations – Made in Germany

The German company MOBOTIX AG is known as the leading pioneer in network camera technology and its decentralized concept has made high-resolution video systems cost-efficient.

MOBOTIX AG • D-67722 Langmeil • Phone: +49 6302 9816-103 • Fax: +49 6302 9816-190 • [sales@mobotix.com](mailto:sales@mobotix.com)

## LED Signaling



- LED off
- LED permanently on

| LED           |   | Meaning                               |
|---------------|---|---------------------------------------|
| Device Status | ● | Regular operation                     |
|               | ● | Error, e.g., input voltage below 12 V |

## Safety Warnings

- This product must not be used in locations exposed to the dangers of explosion.
- Make sure that you install this product as outlined in the installation instructions above.
- The MOBOTIX MX-BPA-Box is to be used only as additional power supply for MOBOTIX MxBus modules in IP65 environments.
- For MOBOTIX cameras with MxBus connector.
- One MX-BPA-Box must not be connected to more than one camera (MxBus master)!
- Make sure that only one MX-BPA-Box is connected to one MxBus!
- Torque for all screws: 0.4 Nm.
- Electrical systems and equipment may only be installed, modified and maintained by a qualified electrician or under the direction and supervision of a qualified electrician in accordance with the applicable electrical guidelines. Make sure to properly set up all electrical connections.
- Make sure that you adhere to all relevant laws, regulations and that you fulfill all certification requirements for the intended use.
- Press the white cable plug (eight-wire plug or cable plug 3–5 mm or 5–7 mm) into the casing in such a way that the rims stick out equally on both sides.
- Make sure to use only shielded twisted-pair cabling (e.g., **J-Y(S)H**) for MxBus wiring.
- The length of the entire MxBus wiring must not exceed 100 m/110 yd.
- Diameter of all wires: 0.6–0.8 mm (0.8 mm = AWG 21 recommended to reduce line losses).

## Technical Specifications

| MX-BPA-Box                          |  |
|-------------------------------------|--|
| Connection                          | MxBus (2x2 terminal connectors)                                      |
| Power Supply                        | External power supply 12–48 V DC                                     |
| Power Consumption                   | 0.5–11.5 W   |
| Output Rating                       | Power supply with 12–23.9 V: 6 W<br>Power supply with 24–48 V: 9 W   |
| Operating Conditions                | IP65 (DIN EN 60529)<br>–30 to +60 °C / –22 to +140 °F (DIN EN 50155) |
| Dimensions (height x width x depth) | 63x87x30 mm/2.48x3.43x1.18 in  |
| Materials                           | Housing: PBT GF30  |
| Weight                              | Approx. 75 g   |

## Drilling Template

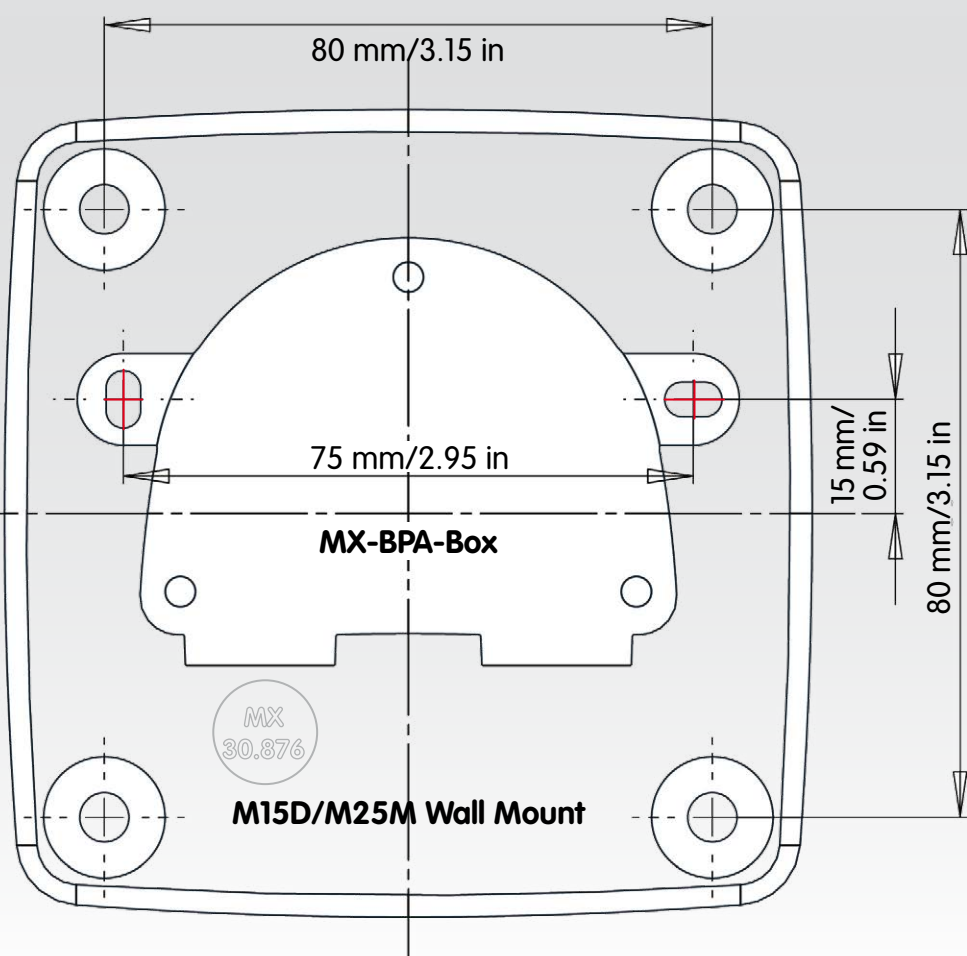

## Innovations – Made in Germany

The German company MOBOTIX AG is known as the leading pioneer in network camera technology and its decentralized concept has made high-resolution video systems cost-efficient.

MOBOTIX AG • D-67722 Langmeil • Phone: +49 6302 9816-103 • Fax: +49 6302 9816-190 • sales@mobotix.com