

# INTL Product Update - February 2022 - English

MOBOTIX MOVE Hardware and Software Updates - Mx6 Software Update - PTZ Control Panel

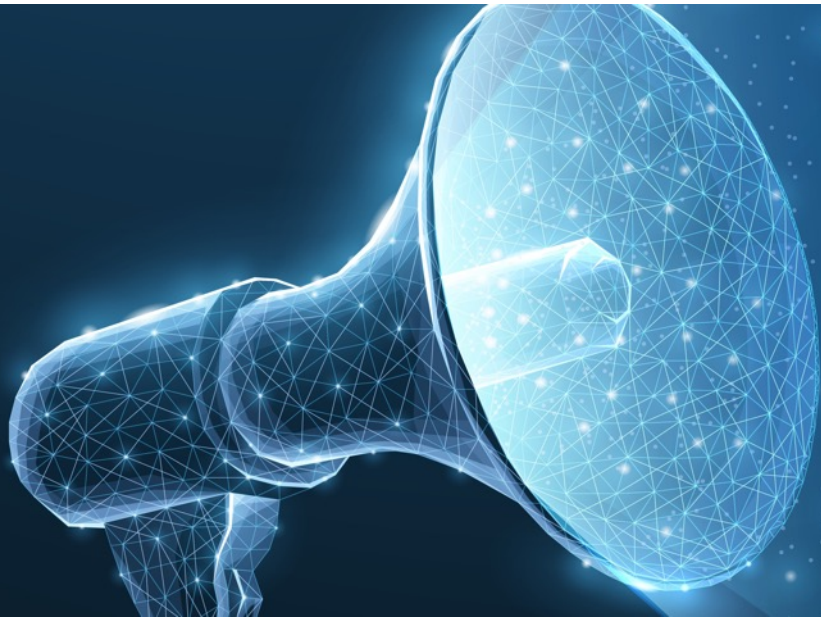

# Overview

---

1. **MOBOTIX MOVE NVR CMS Central Management Software**
2. **MOBOTIX MOVE Updates: Software and Hardware**
3. **Camera Firmware 5.4.6.6 for all MOBOTIX Cameras x16/x26**
4. **MOBOTIX USB Control Panel with PTZ Joystick & Jog Dial**
5. **Price list and important links**

**Notes:** This document is intended for information and requirement planning exclusively for MOBOTIX partners and may not be published in this form (digitally or as a printout) - Delivery only to trade or commercial customers - Prices plus VAT ex works Langmeil, Germany - Subject to change without notice - MOBOTIX assumes no liability for technical errors, typographical errors or omissions - © MOBOTIX AG 2022 - MOBOTIX is a trademark of MOBOTIX AG registered in the European Union, the USA and other countries - All rights reserved.

MOBOTIX MSRP prices are recommended net sales prices Ex Works (EXW), ex works in Germany. In some countries, MOBOTIX distributors have to apply locally higher sales prices due to import regulations/duties.

**Machine translation:** The language version of this document was created using a machine translation service. We apologize for any inconvenience this may have caused.

1.

# MOBOTIX MOVE NVR CMS Central Management Software

# 1. MOBOTIX MOVE NVR CMS Central Management Software

## The perfect software to manage multiple MOBOTIX MOVE NVRs together

The new available [MOBOTIX MOVE NVR CMS](#) is a cost- and license-free, very easy-to-use client software for Windows PCs for centralized remote management (display/playback) of multiple networked MOBOTIX MOVE NVRs at one or more locations and a total of up to **128** connected MOBOTIX MOVE and other ONVIF-compliant cameras. The look and logic of the MOVE NVR CMS user interface is identical to the already known video management software that is part of each MOVE NVR, but has been extended with the corresponding functions for managing multiple NVRs.



### MOBOTIX MOVE NVR

With the [MOVE NVR](#) (Network Video Recorder), MOBOTIX offers particularly practical and easy-to-use plug & play solutions - ideal whenever the existing video analysis functions of the MOBOTIX MOVE cameras are sufficient. All connected cameras are supported by the integrated, cost- and license-free MOBOTIX MOVE NVR video management software, which is tailored to the MOBOTIX MOVE cameras. MOBOTIX MOVE NVR devices support the ONVIF profiles S, T and G and are therefore also suitable for integration into MOBOTIX HUB-based video systems.

# 1. MOBOTIX MOVE NVR CMS Central Management Software

---

## System requirements

Please note the following minimum PC system requirements for installing the CMS software:

- CPU Minimum: Intel CPU Core i3-4150 3.5 GHz (Recommended: Intel CPU Core i7-4770S 3.9 GHz)
- RAM memory Minimum: 2x 4GB (Recommended: 2x 8GB)
- Graphics Minimum: Intel HD Graphics 4400 (Recommended: Intel HD Graphics 530), support 4K video output
- HDD Minimum: 1 TB (Recommended: 2 TB or larger)
- Operating system Microsoft® Windows® 8.1 x64 (Recommended: Microsoft® Windows® 10 x64)
- Ethernet Gigabit LAN
- IP camera input Max. 128 video channels (cameras) live, playback of max. 32 video channels (cameras)

## Supported MOBOTIX MOVE NVR models

The full functionality of the MOBOTIX MOVE NVR CMS is available for the following MOVE NVR models:

- MOBOTIX MOVE NVR 8 Ch Mx-NVR1A-8-POE
- MOBOTIX MOVE NVR 16 Ch Mx-NVR1A-16-POE
- MOBOTIX MOVE NVR 64 Ch Mx-NVR1A-64-POE24

## Scope of functions and user guide of the MOVE NVR CMS Central Management Software

PDF download: [https://www.mobotix.com/sites/default/files/2022-01/Mx\\_ML\\_MOVE\\_CMS\\_V1-03\\_EN.pdf](https://www.mobotix.com/sites/default/files/2022-01/Mx_ML_MOVE_CMS_V1-03_EN.pdf)

## Free download of the program file "*MOBOTIX\_MOVE\_NVR\_CMS\_2021.Q4.1210.3007a9d90.exe*".

Release Notes [https://www.mobotix.com/sites/default/files/2022-01/Release\\_Notes\\_for\\_MOBOTIX\\_MOVE\\_NVR\\_CMS.html](https://www.mobotix.com/sites/default/files/2022-01/Release_Notes_for_MOBOTIX_MOVE_NVR_CMS.html)

Software download: <https://www.mobotix.com/en/node/17764>

Available: immediately



2.

# MOBOTIX MOVE Updates: Software and Hardware

## 2. MOBOTIX MOVE Updates: Software

### System Release for all MOVE NVR models

All cameras connected to a MOBOTIX MOVE NVR (Network Video Recorder) are supported by the integrated, cost- and license-free MOBOTIX MOVE NVR video management software, which is tailored to the MOBOTIX MOVE cameras. MOBOTIX MOVE NVR devices support the ONVIF profiles S, T and G and are therefore also suitable for integration into MOBOTIX HUB-based video systems.

The latest firmware, which will be available from the end of February, offers bug fixes as well as numerous stability and function improvements and is available for free download on the MOBOTIX website with descriptions and version notes.

**MOBOTIX MOVE NVR Firmware Release – Release Notes & Software Download:**  
<https://www.mobotix.com/en/software-downloads>

Available: End of February 2022

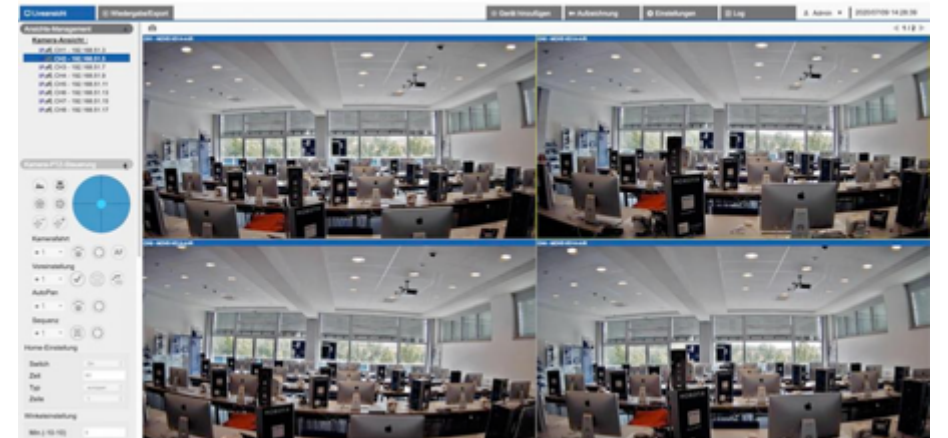

## 2. MOBOTIX MOVE Updates: Software

---

### Free "MOBOTIX MOVE NVR" app

For iOS and Android: A free app that can be used as a mobile VMS solution to display and control all MOBOTIX MOVE cameras connected to a MOBOTIX MOVE NVR (Live View, Playback View). The connection to the MOBOTIX MOVE NVR and the cameras is established locally via an additional WLAN connection. The latest **version 1.2.1** will be available in the stores from the **end of February 2022** including the description of all new features.

Google Play: <https://play.google.com/store/apps/details?id=com.mobotix.movenvr>

App Store: <https://apps.apple.com/de/app/mobotix-move-nvr/id1521256197>

Available: End of February 2022

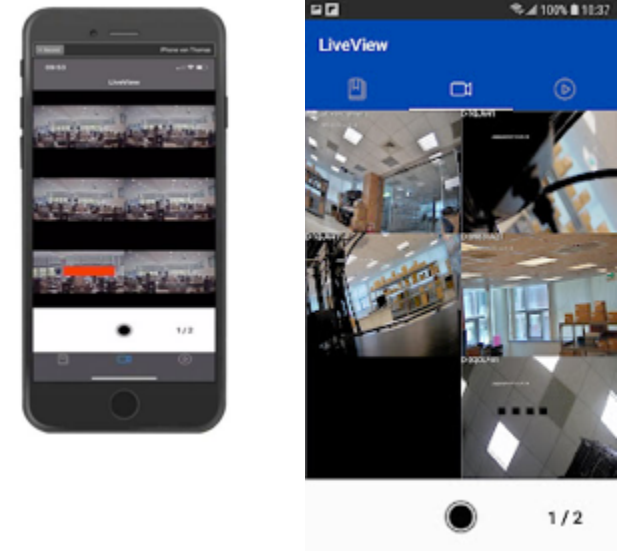

## 2. MOBOTIX MOVE Updates: Hardware

### Successor for MOBOTIX MOVE 2MP Bullet Camera BC1A-2-IR

Our low-cost entry-level model MOBOTIX MOVE Bullet Camera Mx-BC1A-2-IR is **now** being replaced by its successor MOBOTIX MOVE Bullet Camera Mx-BC2A-2-IR, which is largely identical in design but now slightly more powerful.

#### The use of a new, more powerful processor brings the following improvements:

- WDR with max. 130 dB, frame rate of 30 fps at max. resolution and activated WDR
- Angle of view HxV: max. 96.76° x 52.21° (wide angle) to min. 34.13°x19.24° (telephoto)
- Min. ambient brightness: 0.08 lux (color or day mode), or 0.008 lux (b/w or night mode); automatic mechanically switchable IR cut filter
- Integrated IR illumination 850 nm, max. illumination range up to 40 m (depending on scenery and application)
- Recording: internal to microSD card (not included), external to NAS/MOBOTIX MOVE NVR
- Simple video analysis: motion detection, manipulation
- Power supply: PoE IEEE802.3af, Class 0, max. 7.5W

#### Especially practical:

Since the new version BC2A-2-IR has received the identical wall mount of the 4MP and 5MP MOVE Bullet cameras, the accessories available for these models (pole and wall mount, UPoE Network Power Injector) can now also be used.

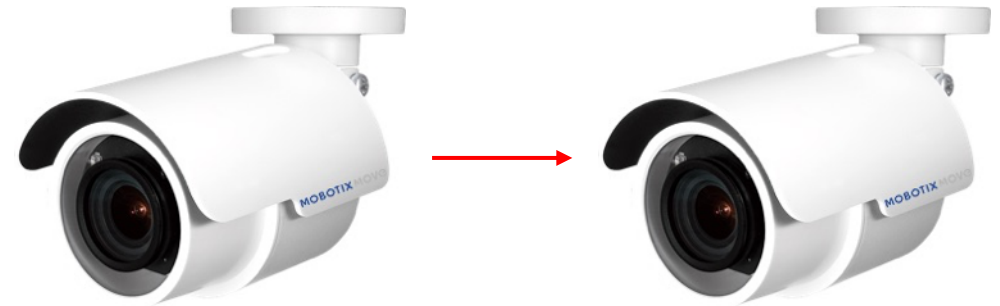

No longer available:  
Mx-BC1A-2-IR

NEW (available now):  
**Mx-BC2A-2-IR**



## 2. MOBOTIX MOVE Updates: Hardware



MOBOTIX MOVE BulletCamera BC2-2-IR and available accessories: Ordering information		
Model name Order number	Description	MSRP Price*
MOBOTIX MOVE BulletCamera BC2-2-IR <a href="#">Mx-BC2A-2-IR</a>	MOBOTIX MOVE Bullet Network Camera BC2-2-IR - Image sensor: 2MP (1920 x 1080), 1/3" progressive CMOS - Weatherproof ONVIF S /G/T bullet camera with integrated IR LEDs (up to 15 m) for day and night use - Automatic switching from color to B/W image (mechanical IR cut filter) - Manually adjustable varifocal lens (F1.4: 2.8 to 12 mm, angle of view H: 91°-34°) - IP66 - Ambient temperature -30 to 60 °C, humidity 10 to 90 % - Video codecs: H.264, H.265, MJPEG (up to 4 streams simultaneous) - WDR (up to 130 dB) - Max. Frame rate: 2MP@60 fps (H.264, H.265 with and without activated WDR function); MJPEG: 1080p@30 fps - Power supply: PoE IEEE 802.3af - MTBF: 95,000h - Warranty: 2 years	379 EUR / 429 USD
Pole holder <a href="#">Mx-M-BC-P</a>	BC mast holder suitable for all MOBOTIX MOVE BulletCameras (except Mx-BC1A-2-IR)	60 EUR / 71 USD
Wall holder <a href="#">Mx-M-BC-W</a>	BC mast holder suitable for all MOBOTIX MOVE BulletCameras (except Mx-BC1A-2-IR)	60 EUR / 71 USD
UPoE Power Injector 60 Watt <a href="#">Mx-NPA-UPoE1A-60W</a>	UPoE (PoE++) 60W network power injector - AC input voltage: 100 to 240 VAC (50 to 60Hz) - AC current draw: 1.5A @100-240 VAC - Operating ambient temperature: -10°C - 45°C) @60W - -10°C - 55°C) @30W - IEEE 802.3at compliant with "2-event" classification - IEEE 802.3af backward compatible - 60W output power over 4-pair CAT - 10/100/1000Base-T support - Plug-and-play installation	128 EUR / 149 USD

\*MOBOTIX MSRP prices are recommended net sales prices Ex Works (EXW), ex works in Germany. In some countries, MOBOTIX distributors have to apply locally higher sales prices due to import regulations/duties.

## 2. MOBOTIX MOVE Updates: Hardware

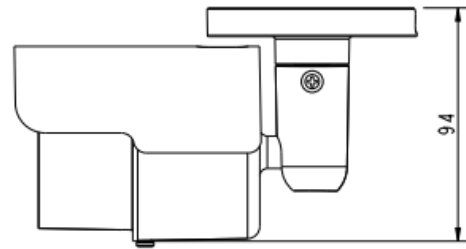
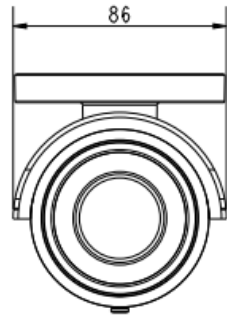
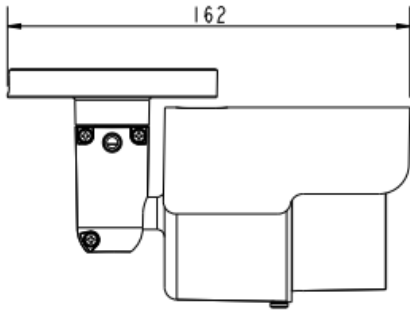
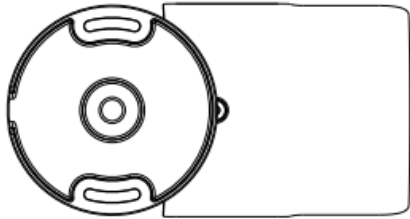

SCALE 0.400

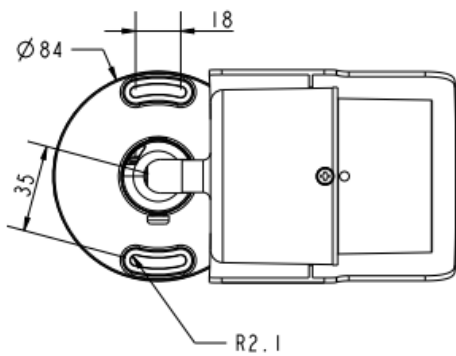

Mx-BC2A-2-IR

### Technical documentation for MOBOTIX MOVE

Technical data sheets: <https://www.mobotix.com/en/support/download-center/documentation/technical-data-sheets>

Quick guides: <https://www.mobotix.com/en/manuals>

Drilling templates: <https://www.mobotix.com/en/drilling-templates>

## 2. MOBOTIX MOVE Updates: Hardware

### End of Life (EoL) of the MOBOTIX MOVE 4MP Bullet and Dome Cameras BC-4-IR, VD-4-IR and VB-4-IR

Due to changing demand towards the current MOBOTIX MOVE model variants with 5MP image sensor and integrated [video analysis tools](#) or the especially cost-effective 2MP entry-level models, we have decided to discontinue the production of all MOBOTIX MOVE Bullet and Dome cameras with 4MP image sensor. If required, these cameras can still be ordered and delivered while stocks last. The 4MP MOVE camera variants with distance lens have already been discontinued by MOBOTIX in mid-2021.



EoL: **BC-4-IR** **VD-4-IR** **VB-4-IR**  
 Alternative: **BC2A-2-IR** **VD-5-IR-VA** **VB-5-IR-VA**

Production stop: Only available while stocks last		
Model name Order number	Description	MSRP Price*
MOBOTIX MOVE BulletCamera BC-4-IR <a href="#">Mx-BC1A-4-IR</a>	MOBOTIX MOVE Bullet Network Camera BC-4-IR - Image sensor: 4MP (2688 x 1512), 1/3" progressive CMOS - Weatherproof ONVIF S/G bullet camera with integrated IR LEDs (up to 30 m) for day and night use - Automatic switching from color to B/W image (mechanical IR cut filter) - Remote zoom - Motor-driven varifocal lens (F1.7: 3 to 9 mm, image angle HxV: 103°-35° x 53°-23°) with "one push" autofocus and P-Iris with automatic adjustment to changing light situations	511 EUR / 618 USD
MOBOTIX MOVE VandalDome VD-4-IR <a href="#">Mx-VD1A-4-IR</a>	MOBOTIX MOVE VandalDome Network Camera VD1A-4-IR - Weatherproof ONVIF S/G dome camera with integrated IR LEDs (up to 30 m) for day and night use - Image sensor: 4MP (2688 x 1512), 1/3" progressive CMOS - Automatic switching from color to B/W image (mechanical IR cut filter) - Remote zoom - Motor-controlled varifocal lens (F1.7: 3 to 9 mm, image angle HxV: 103°-35° x 53°-23°) with "One Push" autofocus and P-Iris with automatic adjustment to changing light situations	511 EUR / 618 USD
MOBOTIX MOVE VandalBullet VB-4-IR <a href="#">Mx-VB1A-4-IR</a>	MOBOTIX MOVE VandalBullet Network Camera VB1A-4-IR - Image sensor: 4MP (2688 x 1512), 1/3" progressive CMOS - Weatherproof ONVIF S/G bullet camera with integrated IR LEDs (up to 30 m) for day and night use - Automatic switching from color to B/W image (mechanical IR cut filter) - Remote zoom - Motor-controlled varifocal lens (F1.6: 2.7 to 12 mm, angle of view H: 99°-31°, V: 53°-18°) with "one push" autofocus and P-Iris with automatic adjustment to changing light situations	716 EUR / 825 USD

\*MOBOTIX MSRP prices are recommended net sales prices Ex Works (EXW), ex works in Germany. In some countries, MOBOTIX distributors have to apply locally higher sales prices due to import regulations/duties.

3.

# Camera Firmware 5.4.6.6 for all MOBOTIX Cameras x16/x26

### 3. Camera Firmware 5.4.6.6 for all MOBOTIX Cameras x16/x26

#### Mx6: Outdoor - Indoor - Thermal

The decentralized and ultra-rugged MOBOTIX Mx6 IoT camera line is state of the art and is constantly being developed to ensure cutting-edge cybersecurity and functionality at all times.

MOBOTIX provides a new firmware update for the entire Mx6 camera series on its homepage for free download. MOBOTIX recommends the update for all Mx6 camera models D16, M16, S16, V16, D26, M26, Q26, S26, T26, c26, i26, p26 and v26. In addition to bug fixes and improvements, this software release MX-V5.4.6.6 is especially required for the camera models M16 and S16, which will be equipped with image sensor modules purchased from now on. The reason for this is an FPGA LX9 hardware adaptation in the image sensor. However, this does not affect the functionality of the image sensor and therefore MOBOTIX has decided to keep the previous order numbers unchanged.

#### Firmware Release 5.4.6.6 – Download & Details:

[mobotix.com > Support > Download Center > Software Downloads > Cameras](https://www.mobotix.com/Support/Download-Center/Software-Downloads/Cameras)

Available: immediately

#### Important notes on identifying the new Mx6 image sensor modules (from the [release notes](#)):

To use the latest image sensor modules, it is mandatory to update the camera (M16/S16) with this software version beforehand, otherwise the sensor modules cannot be addressed. The **new image sensor modules** that are affected can be identified as follows:

- The addition "-LX9" is located directly after the product designation on the packaging, e.g. "Mx-O-SMA-SN061-LX9".
- The label affixed to the sensor module contains the suffix "I" after the type designation, e.g. "SN061I".

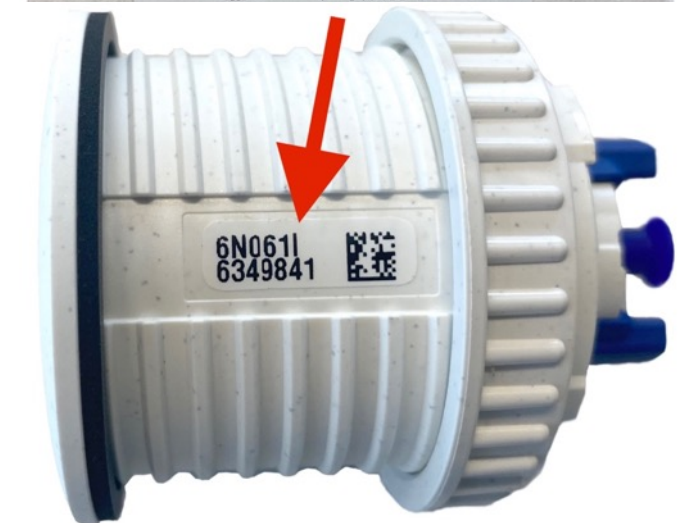

4.

# MOBOTIX USB Control Panel with PTZ Joystick & Jog Shuttle

# 4. MOBOTIX USB Control Panel with PTZ Joystick & Jog Dial



## 4. MOBOTIX USB Control Panel with PTZ Joystick & Jog Dial

The MOBOTIX PTZ Control Panel is a keyboard for controlling MOBOTIX HUB and, especially easy via **Plug & Play**, because with pre-programmed key assignment, MOBOTIX ManagementCenter (MxMC version 2.6 or higher, available in the next few weeks) on a personal computer (Win/Mac OS).

In addition to its high-quality workmanship, the control panel impresses with a considerable simplification and optimization of the user interface by adding a joystick (PTZ & zoom) and a jog dial (forward/reverse and single frame switching) to the control system - for optimal operation of motor-controlled or hemispherical cameras, suitable for both right-handed and left-handed users.

The keyboard is equipped with an internal buzzer and with a backlight for the keys. The connection to the PC is easily done via USB.

**Quick Install:** [https://www.mobotix.com/sites/default/files/2022-01/Mx\\_QI\\_PTZ-Keyboard\\_v2-2.pdf](https://www.mobotix.com/sites/default/files/2022-01/Mx_QI_PTZ-Keyboard_v2-2.pdf)

**User Manual:** [https://www.mobotix.com/sites/default/files/2022-01/Mx\\_ML\\_PTZ-Keyboard\\_v2-2.pdf](https://www.mobotix.com/sites/default/files/2022-01/Mx_ML_PTZ-Keyboard_v2-2.pdf)



MOBOTIX USB Control Panel with PTZ Joystick & Jog Shuttle: Ordering Information		
Model name Order number	Description	MSRP Price*
MOBOTIX USB Control Panel with PTZ Joystick & Jog Shuttle <a href="#">Mx-A-KBD1A-PTZ-JOG</a>	USB control panel for operating MOBOTIX MxMC 2.6 and higher (Plug&Play) and MOBOTIX HUB incl. Control of software PTZ and motorized PTZ cameras and pan/tilt devices - Integrated 3-axis joystick - Integrated jog dial - 38 control keys with backlight predefined for MxMC functions or freely definable for MOBOTIX HUB - Integrated alarm buzzer - Suitable for operation as HID device on MOBOTIX VMS with Windows and MAC based operating systems via USB2.0 - Suitable for right- and left-handed users - Power supply: USB, max. 350 mA - Operating temperature: 0° - 45 °C (32 °F- 113 °F)	639 EUR / 749 USD

\*MOBOTIX MSRP prices are recommended net sales prices Ex Works (EXW), ex works in Germany. In some countries, MOBOTIX distributors have to apply locally higher sales prices due to import regulations/duties.

5.

# Price List and Important Links

## 5. Price List and Important Links

---

### **New products on the MOBOTIX website:**

[www.mobotix.com](http://www.mobotix.com) > [Products](#) (Hardware)

[www.mobotix.com](http://www.mobotix.com) > [Support > Download Center](#) (Software)

[www.mobotix.com](http://www.mobotix.com) > [Support > Download Center](#) (Documentation)

### **New price lists on the MOBOTIX website:**

[Customer Portal](#) (In the non-public partner area: Interactions > Sales tools > Price lists)

**MOBOTIX sales support (brochures, presentations, videos, ...) can be found in the MOBOTIX Partner Toolbox for PC, Tablet and Smartphone:**

> [App Store](#)

> [Google Play](#)

> [website](#)

### **All product trainings and events (current events):**

[Company > Calendar](#)

# Become part of the MOBOTIX Community!

---



**MOBOTIX Community**



## **The MOBOTIX Community - support around the clock**

Are you a MOBOTIX partner, customer, user or just technically very interested in our innovative quality products like the smart cameras "Made in Germany", MOBOTIX 7 camera apps with latest AI technology or the modern VMS solutions like MOBOTIX HUB or MOBOTIX CLOUD?

Visit our community platform now! Our technical support experts and experienced external users provide tips on how to set up and use MOBOTIX solutions - and troubleshoot if necessary. In addition to numerous valuable technical information and tips, you can of course also exchange ideas with other members of the worldwide MOBOTIX family in the user forum.

Registration and use of the MOBOTIX Community are of course free of charge: <https://community.mobotix.com>

---

BeyondHuman**Vision**

**MOBOTIX**

MOBOTIX AG  
Kaiserstrasse  
67722 Langmeil  
Germany

+49 6302 9816-0  
info@robotix.com  
www.robotix.com

MOBOTIX, the MOBOTIX Logo, MxControlCenter, MxEasy, MxPEG, MxDisplay and MxActivitySensor are trademarks of MOBOTIX AG registered in the European Union, the U.S.A. and in other countries • Subject to change without notice • MOBOTIX do not assume any liability for technical or editorial errors or omissions contained herein • All rights reserved • © MOBOTIX AG